

CARACTERÍSTICAS TÉCNICAS | Technical Characteristics

MATERIAL **Aço**
 ACABAMENTO **Metalizado e Pintado**
 (Cores Corten ou Antracite, texturados)
 COLOCAÇÃO **Em fundação de betão**
 PESO APROX. **23 KG**
 CAPACIDADE **48 Lt + CINZEIRO**

MATERIAL **Steel**
 FINISH **Metallized and painted steel**
 (Corten/Anthracite textured colors)
 FIXING **Set to concrete base**
 WEIGHT **23 KG**
 CAPACITY **48 Lt + ASHTRAY**



DESIGN Dep. Técnico AMOP

Dimensões (mm)

Desenho Técnico | Technical Drawing

Papeleira 48Lt + Cinzeiro
 48 Lt Paper bin + Ashtray

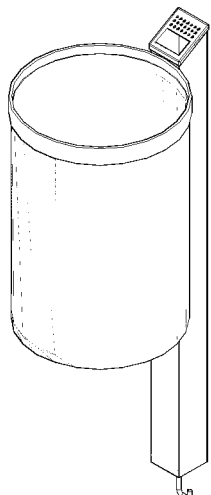

MODELAÇÃO
 Modeling

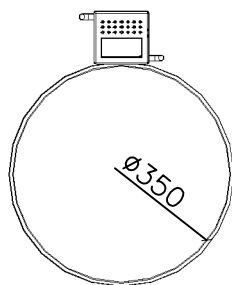

PLANTA
 TopView

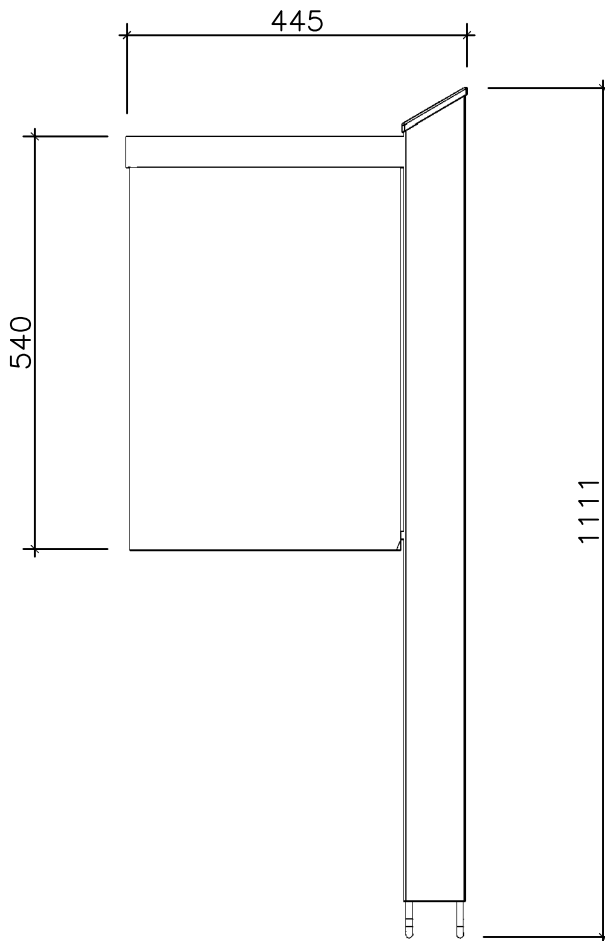

ALÇADO LATERAL
 Side View

APLICAÇÃO | Installation

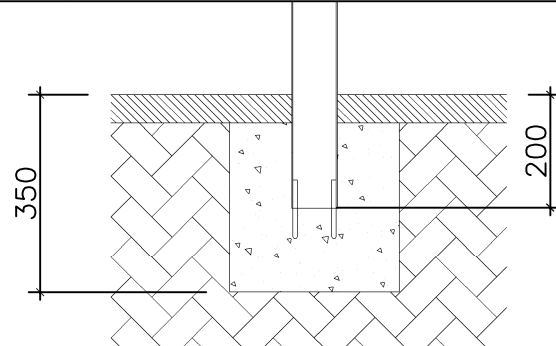
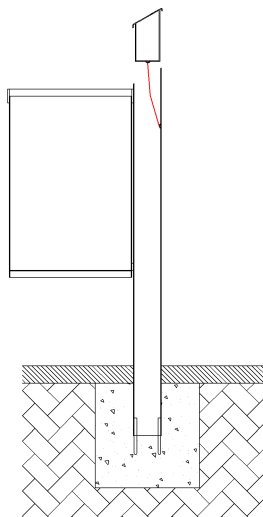
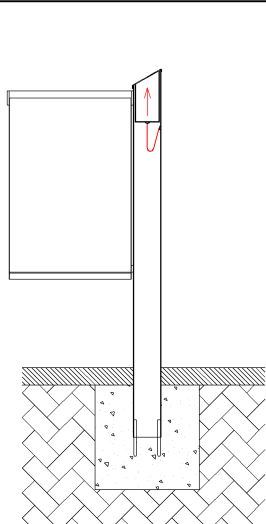

RECOMENDA-SE APLICAÇÃO EM SAPATA EM
 BETÃO 30x30x30 cm, CONFORME PORMENOR
 RECOMMENDED INSTALLATION IN 30x30x30 cm
 CONCRETE FOUNDATION AS DETAIL

AMP.019/00 EDIÇÃO 0 DATA: 29-08-2011



APARTADO 38 3754-906 AGUADA DE BAIXO ÁGUEDA - PORTUGAL
 TEL 234667957 FAX 234666908
 ecn2@grupoamop.com www.ecn2.eu

PAPELEIRA 3A

REF.^a - 13036

FT.13036.V1 Folha | Page 1-1